

- NOTES**
- DO NOT SCALE FROM THIS DRAWING.
  - ALL MEASUREMENTS ARE IN MILLIMETRES UNLESS STATED OTHERWISE.
  - THIS DRAWING IS TO BE READ IN CONJUNCTION WITH THE SPECIFICATION AND ALL RELEVANT ARCHITECTURAL, ELECTRICAL, MECHANICAL AND STRUCTURAL DRAWINGS.

**carillion**

For information

For comment

For client sanction

For construction

This drawing has been reviewed against the contractors risk register and notes added to fully describe all residual risks.

Confirmed by:  P. Gott

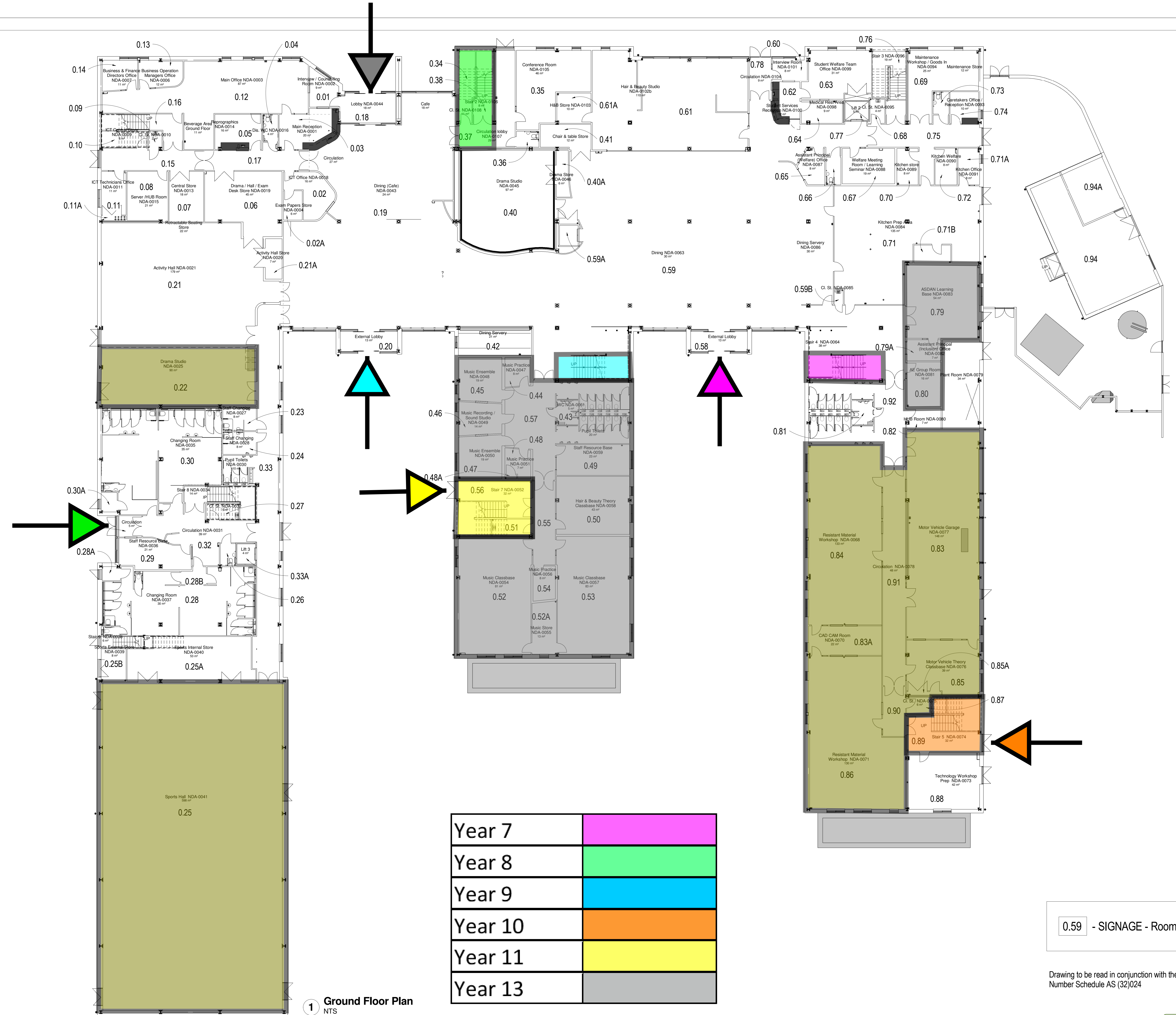

**1** Ground Floor Plan  
NTS

Year 7	
Year 8	
Year 9	
Year 10	
Year 11	
Year 13	

**0.59** - SIGNAGE - Room number reference

Drawing to be read in conjunction with the SIGNAGE - Room Name and Number Schedule AS (32)024

**APPROVED**  
By 01gd01 at 7:33 pm, Aug 19, 2020

**SAFETY HEALTH AND ENVIRONMENTAL INFORMATION**

For details of site-wide and general risks, to be read in conjunction with these notes, see Design Risk Register ref. In addition to the risks normally associated with the types of work detailed on this drawing, note the following risks and information:

CONSTRUCTION

01	
02	
03	

It is assumed that all works will be carried out by a competent contractor working, where appropriate, to an approved Method Statement

**FINAL CONSTRUCTION ISSUE**

Rev	Description	Date	By	Check	Auth

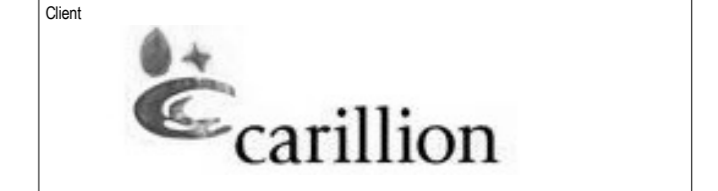

**ATKINS**  
Atkins Limited  
2000 Park  
Leeds, West Yorkshire  
LS10 1JQ, England  
Telephone: +44 (0)113 286 0000  
Fax: +44(0)113 286 0002

Project: **North Durham Academy**

Drawing Title: **Ground Floor - SIGNAGE Room Numbering Plan**

Original Scale	Original Date	Designed	Drawn	Checked	Approved
NTS	01/02/13	02/02/13	05/02/13	06/02/13	06/02/13
Office	LED	02/02/13	05/02/13	06/02/13	06/02/13
Drawing Number	5094954 - (32) 020				Rev
					B

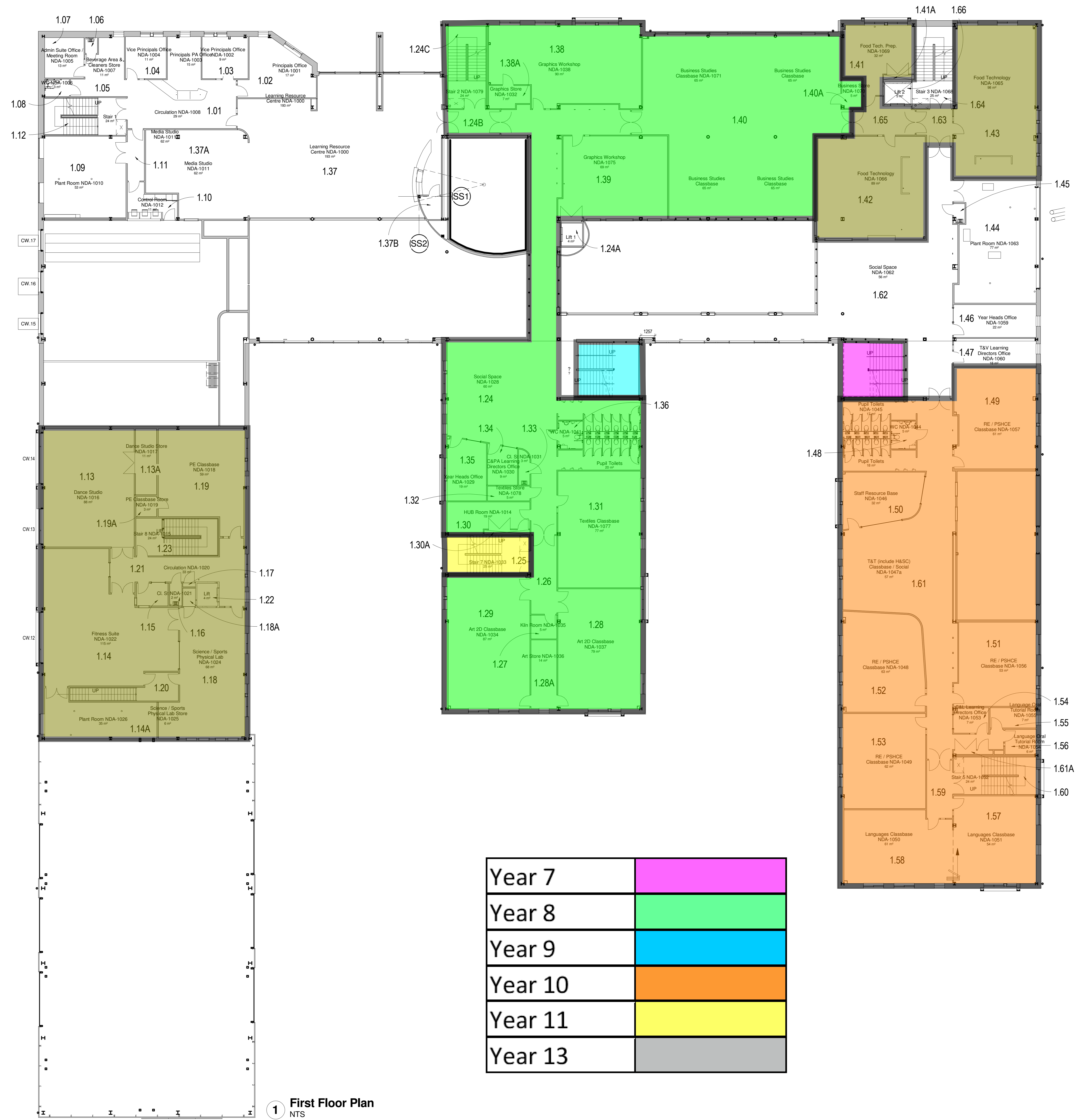

1 First Floor Plan  
NTS

Year 7	
Year 8	
Year 9	
Year 10	
Year 11	
Year 13	

1.59 - SIGNAGE - Room number reference

Drawing to be read in conjunction with the SIGNAGE - Room Name and Number Schedule AS (32)024

**APPROVED**  
By 01gd01 at 7:33 pm, Aug 19, 2020

**NOTES**

- DO NOT SCALE FROM THIS DRAWING.
- ALL MEASUREMENTS ARE IN MILLIMETRES UNLESS STATED OTHERWISE.
- THIS DRAWING IS TO BE READ IN CONJUNCTION WITH THE SPECIFICATION AND ALL RELEVANT ARCHITECTURAL, ELECTRICAL, MECHANICAL AND STRUCTURAL DRAWINGS.

**carillion**

For information   
 For comment   
 For client sanction   
 For construction

This drawing has been reviewed against the contractors risk register and notes added to fully describe all residual risks.

Confirmed by:  P. Gott

**SAFETY HEALTH AND ENVIRONMENTAL INFORMATION**

For details of site-wide and general risks, to be read in conjunction with these notes, see Design Risk Register ref. In addition to the risks normally associated with the types of work detailed on this drawing, note the following risks and information:

CONSTRUCTION

01					
02					
03					

It is assumed that all works will be carried out by a competent contractor working, where appropriate, to an approved method statement.

**FINAL CONSTRUCTION ISSUE**

Rev	Description	Date	By	Check	Auth
-----	-------------	------	----	-------	------

**carillion**

**ATKINS**

Atkins Limited  
200 Park Road  
Leeds, West Yorkshire  
LS10 5JF, UK  
Telephone: +44 (0)113 286 0000  
Fax: +44(0)113 286 0002

Project: North Durham Academy

Drawing Title: First Floor - SIGNAGE Room Numbering Plan

Original Scale	Original Date	Designed	Drawn	Checked	Approved
NTS	05.02.13	05.02.13	05.02.13	05.02.13	05.02.13
Office	LED	05.02.13	05.02.13	05.02.13	05.02.13
Drawing Number	5094954- (32) 021				Rev
					B

- NOTES**
- DO NOT SCALE FROM THIS DRAWING.
  - ALL MEASUREMENTS ARE IN MILLIMETRES UNLESS STATED OTHERWISE.
  - THIS DRAWING IS TO BE READ IN CONJUNCTION WITH THE SPECIFICATION AND ALL RELEVANT ARCHITECTURAL, ELECTRICAL, MECHANICAL AND STRUCTURAL DRAWINGS.

**carillion**

For information   
 For comment   
 For client sanction   
 For construction

This drawing has been reviewed against the contractors risk register and notes added to fully describe all residual risks.

Confirmed by:  P. Gott

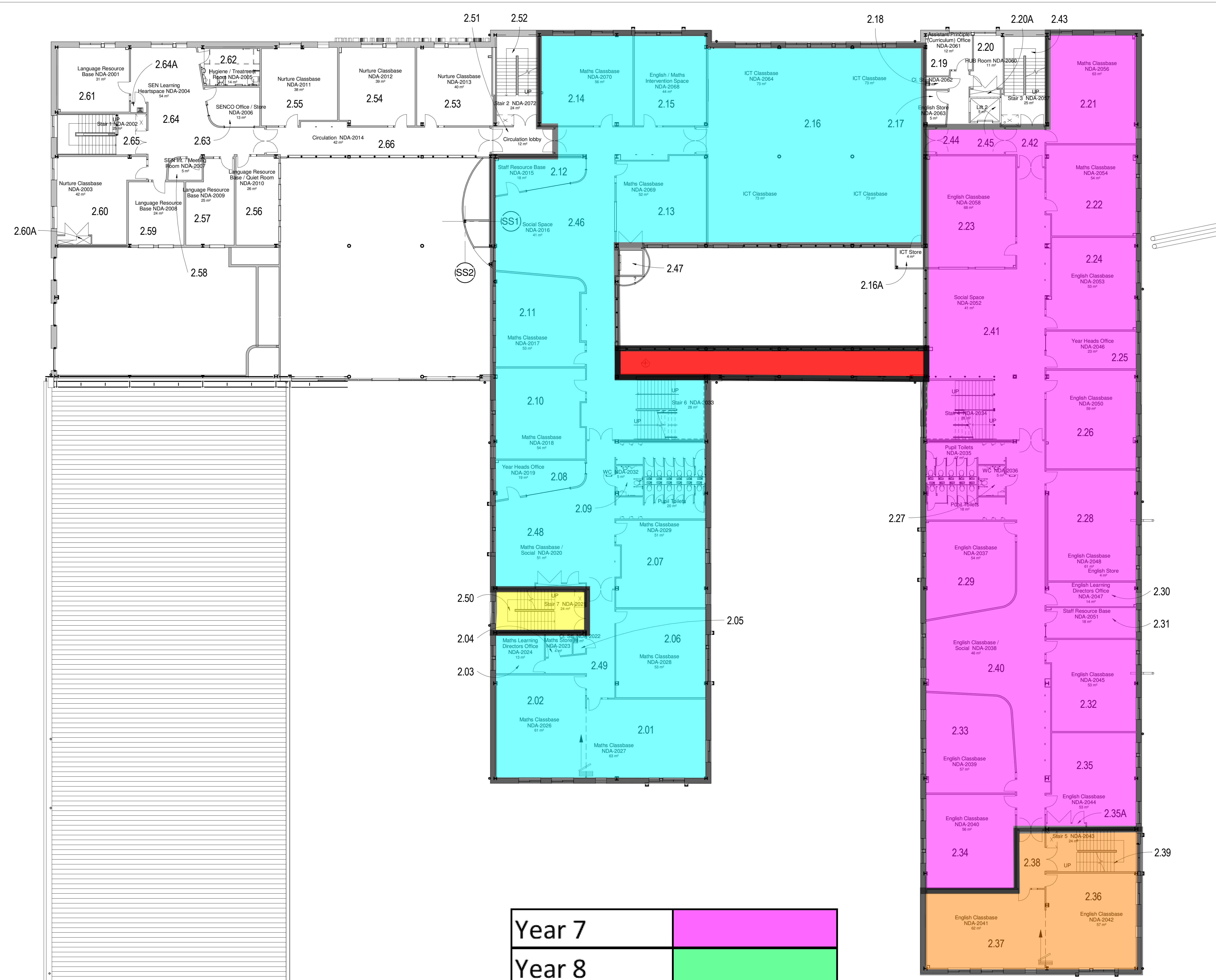

Year 7	
Year 8	
Year 9	
Year 10	
Year 11	
Year 13	

2.59 - SIGNAGE - Room number reference

**1 Second Floor Plan**  
NTS

Drawing to be read in conjunction with the SIGNAGE - Room Name and Number Schedule AS (32)024

**APPROVED**  
By 01gd01 at 7:34 pm, Aug 19, 2020

**SAFETY HEALTH AND ENVIRONMENTAL INFORMATION**

For details of site-wide and general risks, to be read in conjunction with these risks, see Design Risk Register and...  
 In addition to the risks normally associated with the types of work detailed on this drawing, note the following risks and information:

- CONSTRUCTION**
- 01
  - 02
  - 03

It is assumed that all works will be carried out by a competent contractor working, where appropriate, to an approved Method Statement

**FINAL CONSTRUCTION ISSUE**

No.	Description	Date	By	Check	Auth
1					

**carillion**

**ATKINS**

Atkins Limited  
 200 Parkway  
 1000 Westborough  
 England

Telephone: +44 (0)113 386 000  
 Fax: +44(0)113 386 002

Project: **North Durham Academy**

Drawing Title: **Second Floor - SIGNAGE Room Numbering Plan**

Original Scale	Original Date	Designed	Drawn	Checked	Approved
NTS	01/02/13	02/02/13	02/02/13	02/02/13	02/02/13
Office	LED	02/02/13	02/02/13	02/02/13	02/02/13

Drawing Number: 5094954- (32) 022

- NOTES**
- DO NOT SCALE FROM THIS DRAWING.
  - ALL MEASUREMENTS ARE IN MILLIMETRES UNLESS STATED OTHERWISE.
  - THIS DRAWING IS TO BE READ IN CONJUNCTION WITH THE SPECIFICATION AND ALL RELEVANT ARCHITECTURAL, ELECTRICAL, MECHANICAL AND STRUCTURAL DRAWINGS.



For information

For comment

For client sanction

For construction

This drawing has been reviewed against the contractors risk register and notes added to fully describe all residual risks.

Confirmed by:

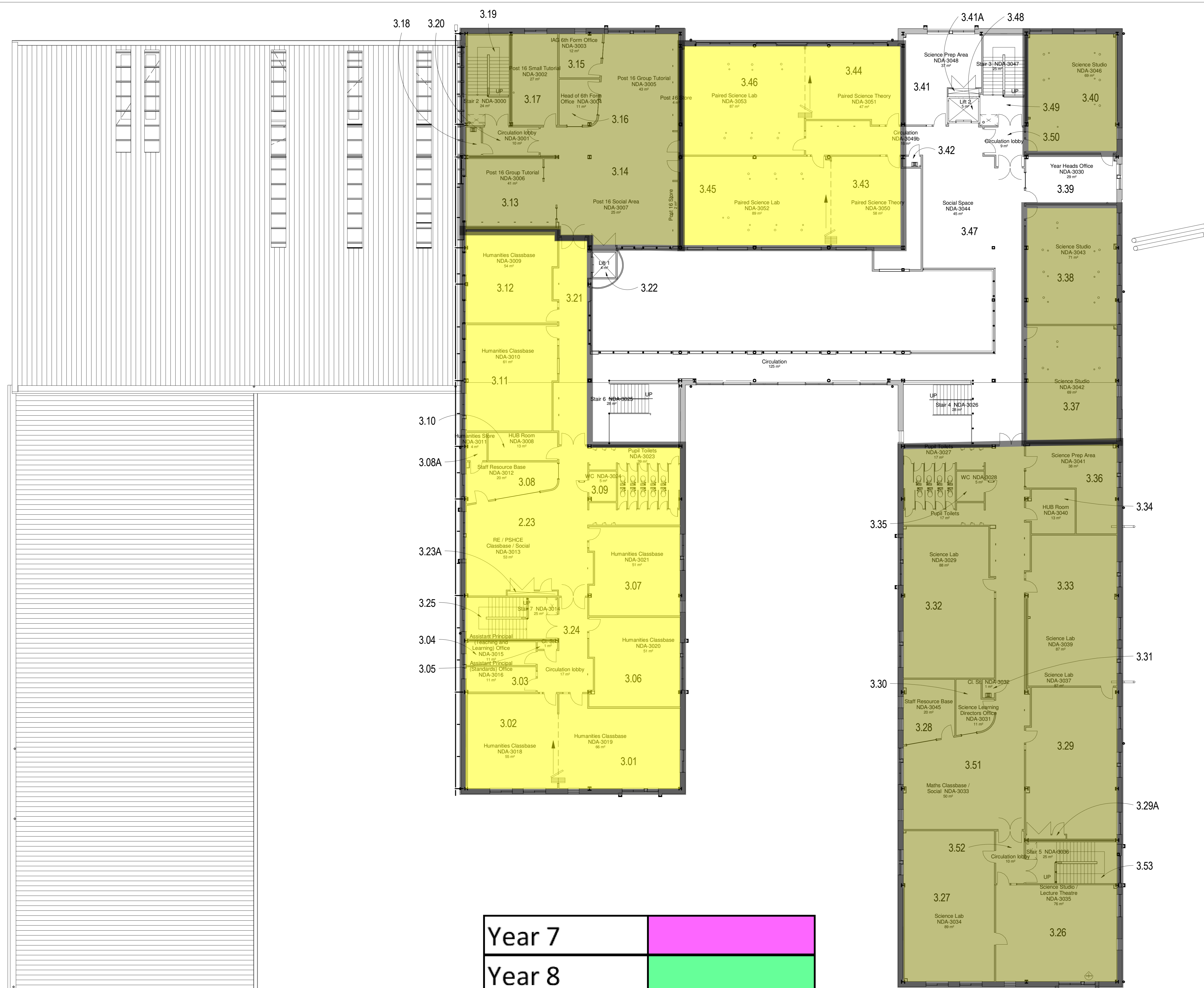

Year 7	
Year 8	
Year 9	
Year 10	
Year 11	
Year 13	

3.59 - SIGNAGE - Room number reference

Drawing to be read in conjunction with the SIGNAGE - Room Name and Number Schedule AS (32)024

**APPROVED**  
By 01gd01 at 7:34 pm, Aug 19, 2020

**Third Floor Plan**  
NTS

**SAFETY HEALTH AND ENVIRONMENTAL INFORMATION**

For details of site-wide and general risks, to be read in conjunction with these notes, see Design Risk Register ref.

In addition to the risks normally associated with the types of work detailed on this drawing, note the following risks and information:

CONSTRUCTION

01	
02	
03	

It is assumed that all works will be carried out by a competent contractor working, where appropriate, to an approved method statement.

**FINAL CONSTRUCTION ISSUE**

Rev	Description	Date	By	Check	Auth
1					



**ATKINS**  
Atkins Limited  
200 Parkway  
Leeds, West Yorkshire  
LS10 2JQ  
England  
Telephone: +44 (0)113 286 0000  
Fax: +44(0)113 286 0002

Project: **North Durham Academy**

Client Title: **Third Floor - SIGNAGE Room Numbering Plan**

Original Issue	Original Date	Design	Drawn	Checked	Approved
NTS	Office	LED	05.02.13	05.02.13	05.02.13
05094954-	(32) 023				B